

NOTICE OF STUDY COMMENCEMENT
Shellard Lane Development – Special Policy Area 20
Integrated Municipal Class Environmental Assessment
City of Brantford

Study

The LIV Community Development Landowners Group (Landowners Group) is proposing to develop lands which include properties north of Shellard Lane within Area C Lands of the Special Policy Area 20 with support of their Planning Consultant Arcadis Professional Services, and Environmental Assessment Consultant R.J. Burnside & Associates. The subject lands are located in the southwest quadrant of the City of Brantford and generally lie between Shellard Lane and the CN Rail Trail. The planning application is an Official Plan and Zoning By-law Amendment, Draft Plan of Subdivision, (PI-03-24).

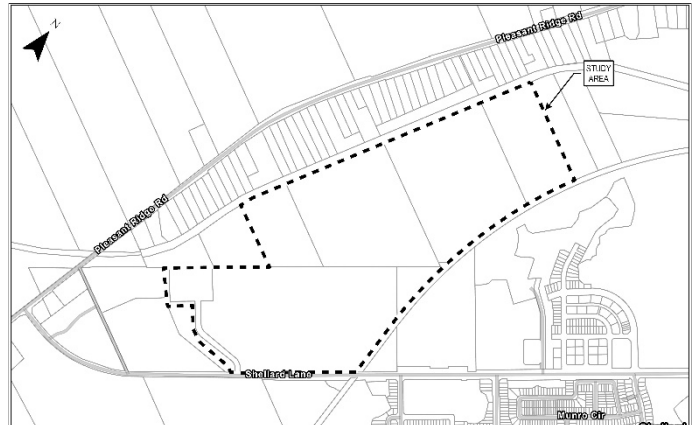

In support of a future site plan and the required collector roads, the Landowners Group has initiated an Integrated Municipal Class Environmental Assessment (EA). It is intended that the Integrated Municipal Class EA process will also build upon the City of Brantford's Transportation Master Plan, Active Transportation Master Plan Study, Master Servicing Plans, Parks and Recreation Master Plan and Section 6.9.20 of the City's Official Plan. The Study Area is illustrated in the Figure shown above.

Process

The study is being completed as a Schedule C Municipal Class EA process through an integrated planning approach as set out in the Municipal Class Environmental Assessment process (Municipal Engineers Association, March 2023) which is an approved process under the *Ontario Environmental Assessment Act*.

The process will include consultation and engagement with the public, agencies, City of Brantford, local developers, and Indigenous communities. The Integrated Municipal Class EA will evaluate alternative solutions for the collector roads, with consideration of the natural, cultural, technical, and financial environment and recommend a preferred solution associated with the future site plan.

Public Information Centres (PICs) are planned to discuss issues related to the required collector roads and the potential road network; including alternative solutions and designs, evaluation criteria, environmental impacts and mitigation measures. PIC dates and details will be advertised as the study progresses. Further information about the project and planning process can be found at <https://www.rjburnside.com/shellard-lane-development>

Comments Invited

You are encouraged to provide your comments so that they may be incorporated into the planning of this project. If you have questions or comments regarding the Study or would like to be added to the Project Contact List, please email shellardlanedevelopment@rjburnside.com or contact one of the following Project Team members:

Ben Jones
Senior Land Development Manager
LIV Communities
1005 Skyview Drive, Suite 301,
Burlington, ON L7P 5B1
Phone: 289-245-1300 ext. 522
Email: bjones@livhere.ca

Philip A. Rowe, C.E.T., EP.
Consultant Project Manager
R.J. Burnside & Associates Limited
1266 South Service Road, Suite C2
Stoney Creek, ON L8E 5R9
Phone: 905-821-5915
Email: philip.rowe@rjburnside.com

Information will be collected in accordance with the *Freedom of Information and Protection of Privacy Act*. With the exception of personal information, all comments will become part of the public record. Project and notice information will be made accessible upon request in accordance with the Accessibility Standard for Information and Communication under the *Accessibility for Ontarians with Disabilities Act, 2005*.

This Notice first issued on March 28, 2024