

NOTICE OF PUBLIC INFORMATION CENTRE
Shellard Lane Development – Special Policy Area 20
Integrated Municipal Class Environmental Assessment
City of Brantford

Study

The LIV Community Development Landowners Group (Landowners Group) is proposing to develop lands which include properties north of Shellard Lane within Area C Lands of the Special Policy Area 20 with support of their Planning Consultant Arcadis Professional Services, and Environmental Assessment Consultant R.J. Burnside & Associates. The subject lands are located in the southwest quadrant of the City of Brantford and generally lie between Shellard Lane and the CN Rail Trail. The planning application is an Official Plan and Zoning By-law Amendment, Draft Plan of Subdivision, (PI-03-24).

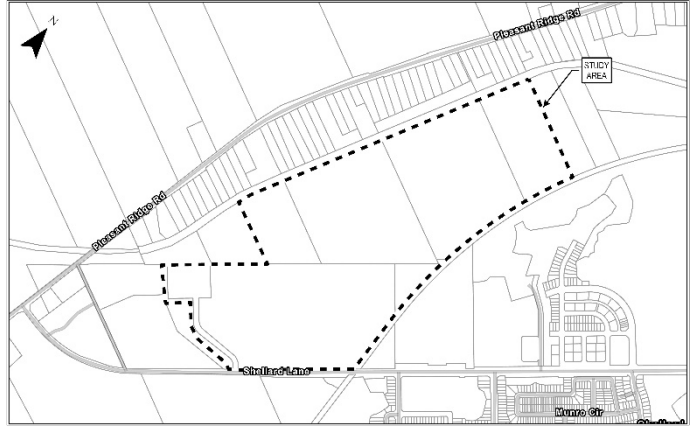

In support of a future site plan and the required collector roads, the Landowners Group is conducting an Integrated Municipal Class Environmental Assessment (MCEA). It is intended that the integrated MCEA will also build upon the City of Brantford's Transportation Master Plan, Active Transportation Master Plan Study, Master Servicing Plans, Parks and Recreation Master Plan and Section 6.9.20 of the City's Official Plan. The Study Area is illustrated in the Figure shown above.

Process

The study is being completed as a Schedule C MCEA process through an integrated planning approach as set out in the Municipal Class Environmental Assessment process (Municipal Engineers Association, February 2024) which is an approved process under the *Ontario Environmental Assessment Act*. The integrated MCEA will evaluate alternative solutions for the collector roads, with consideration of the natural, cultural, technical, and financial environment and recommend a preferred solution in consultation with agencies, stakeholders, Indigenous communities, the public and associated with the future area site plans.

Public Information Centre No. 2

You are invited to attend the Public Information Centre to provide your input. The Landowners Group and its consultant will be present to discuss the study and answer your questions. Following the Public Information Centre, project information displayed will also be available for viewing at: <https://www.rjburnside.com/shellard-lane-development>

Date: Friday, December 20, 2024
Time: Drop-in 7:30p.m. – 9:30 p.m.
Location: Saint Basil / Walter Gretzky Catholic Elementary School
365 Blackburn Dr, Brantford, ON N3T 0G5

AND

Date: Wednesday, January 15, 2025
Time: Drop-in 7:30p.m. – 9:30 p.m.
Location: Saint Theresa School
12 Dalewood Ave, Brantford, ON N3T 5L7

Please note: A Neighbourhood Meeting for the Proposed Official Plan and Zoning By-law Amendment for Shellard Lane Special Policy Area 20 will also be occurring during the same times at the same locations as the PIC #2 Meeting.

To provide comment or to request additional information please email shellardlanedevelopment@rjburnside.com or contact one of the following Project Team members:

Ben Jones
Senior Land Development Manager
LIV Communities
1005 Skyview Drive, Suite 301,
Burlington, ON L7P 5B1
Phone: 289-245-1300 ext. 522

Philip A. Rowe, C.E.T., EP.
Consultant Project Manager
R.J. Burnside & Associates Limited
1266 South Service Road, Suite C2
Stoney Creek, ON L8E 5R9
Phone: 905-821-5915

Information will be collected in accordance with the *Freedom of Information and Protection of Privacy Act*. With the exception of personal information, all comments will become part of the public record. Project and notice information will be made accessible upon request in accordance with the Accessibility Standard for Information and Communication under the *Accessibility for Ontarians with Disabilities Act, 2005*.

This Notice first issued on December 5, 2024.